

Windows 8 HC board drivers installation guide

This document will help you to install drivers for HC boards on Windows 8 OS. Due to some changes in Microsoft policy regarding driver signatures, driver installation process is different from one in Windows 7. Now, in order to install drivers for Luxriot HC borders, system must be booted up in "*Disable Driver Signature Enforcement*" mode.

To start up system in "*Disable Driver Signature Enforcement*" mode follow this steps:

- 1) go to start screen (press *win* button on keyboard)
- 2) activate menu on the right of the screen and select search
- 3) enter "*advanced startup*" and select that you want to search it in "*Settings*" category on the right side of screen.

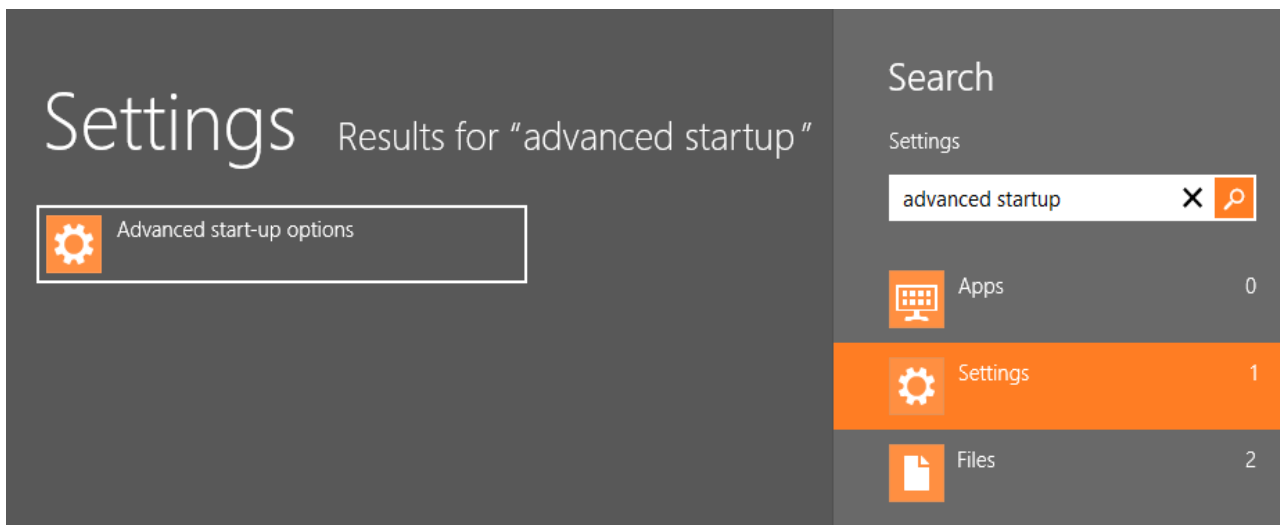

- 4) settings will be opened, scroll to the down of the screen and press "*restart now*" button under "*Advanced start-up*" section.

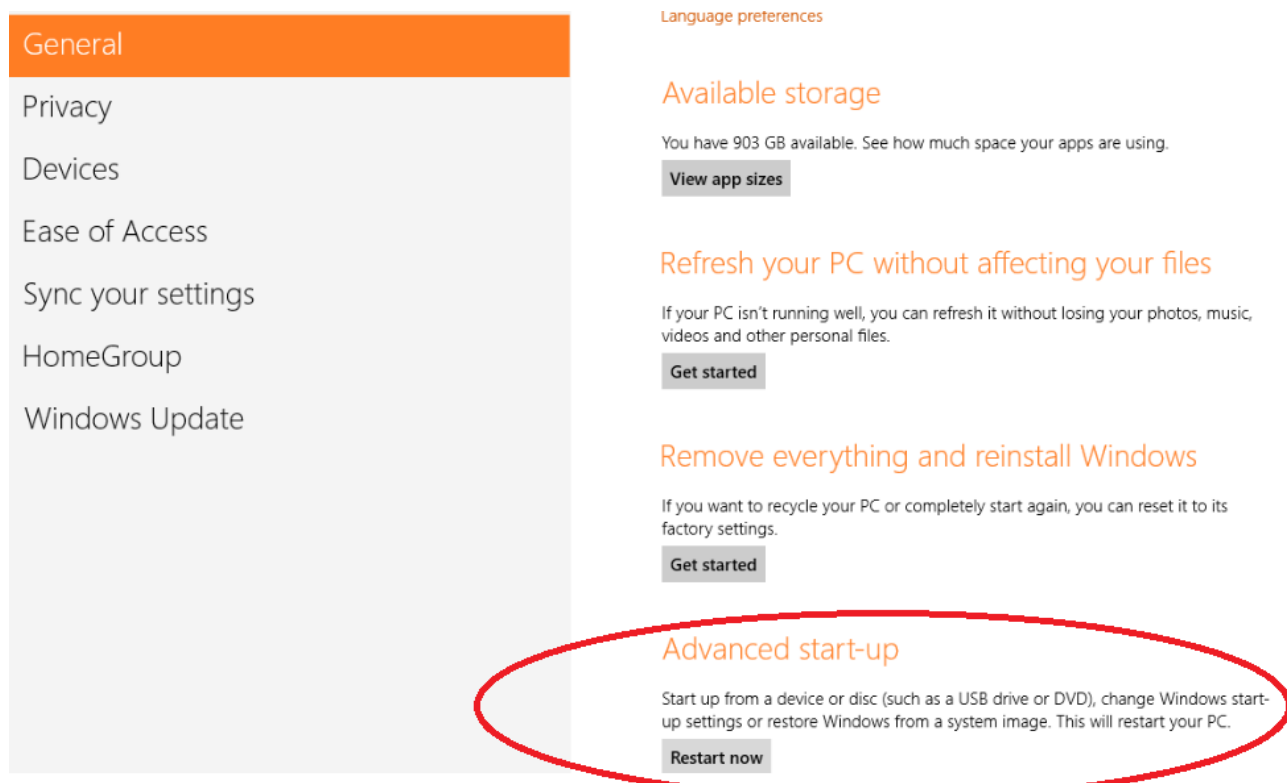

5) you will be logged out and settings window will appear, select “*Troubleshooting*”->”*advanced options*”->”*start-up settings*”->”*restart*”

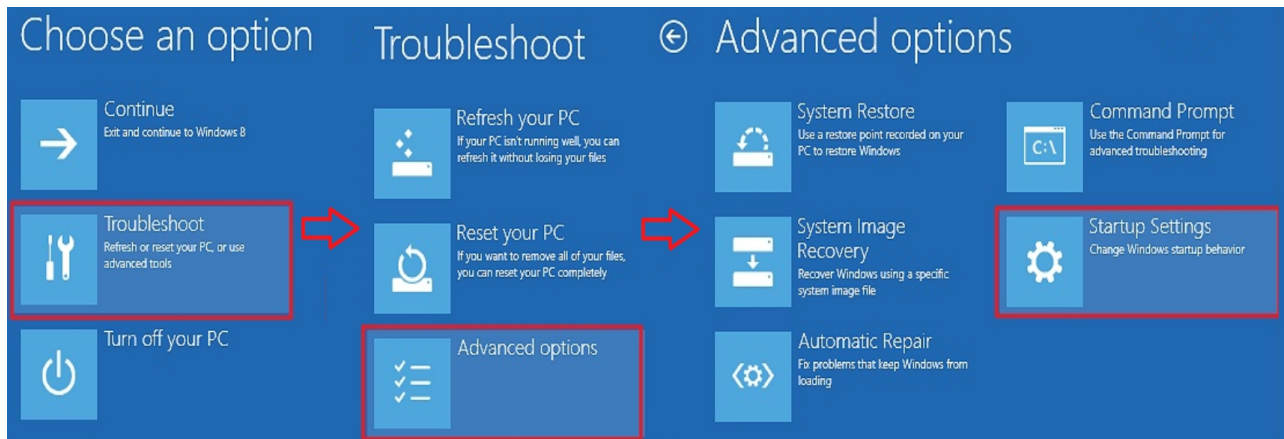

6) machine will reboot

7) on boot time you will be asked what to do, you will need to select “*Disable driver signature enforcement*”.

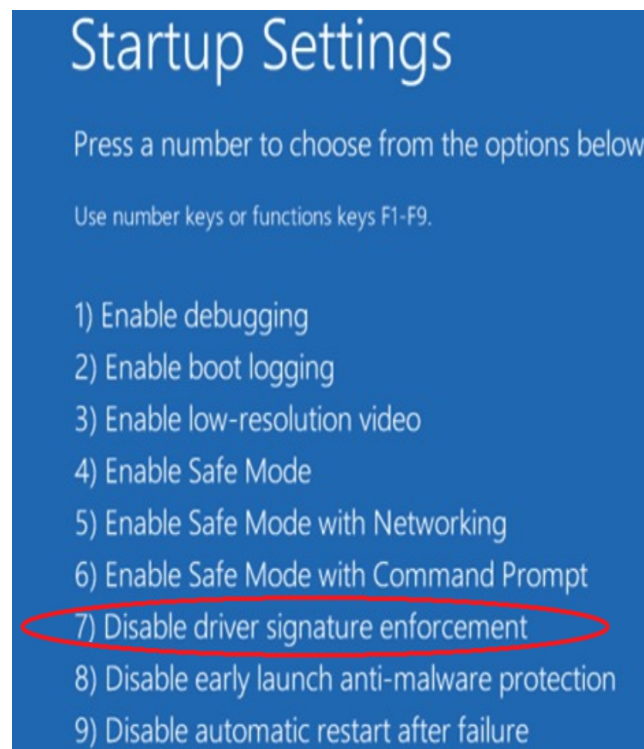

8) machine will boot up and you will be able to install drivers as previously in Windows 7.

9) after driver install the machine should be rebooted again to return to normal operation mode.